



Planning Department
Waterford City & County Council
Menapia Building
The Mall
Waterford

Date: 29-08-21

Attention: Director of Services

Subject: Rezoning Submission for Lands at Greenway Manor Hotel, Old Court, Killotteran, Waterford for Sean Johnston

Dear Sir/ Madam,

On behalf of Mr Sean Johnston and in reference to the above site, please find below submission for lands to be included as part of the rezoning

- Mr Sean Johnston wishes to have existing land rezoned from Mixed / General Green / Recreation / Conservation / Other to Tourism as identified on the accompanying Appendix A - Overlay with Current Draft Zoning Map and Appendix B - Site Location Map.
- The rezoning of the land around the property will allow for the further development of the hotel.

I trust that the above is to your satisfaction and look forward to a favorable decision in this regard.

Yours sincerely,

Mark Weldon



APPENDIX A - OVERLAY WITH CURRENT DRAFT ZONING MAP





Lands Proposed To Be
Zoned Tourism



APPENDIX B - SITE LOCATION MAP



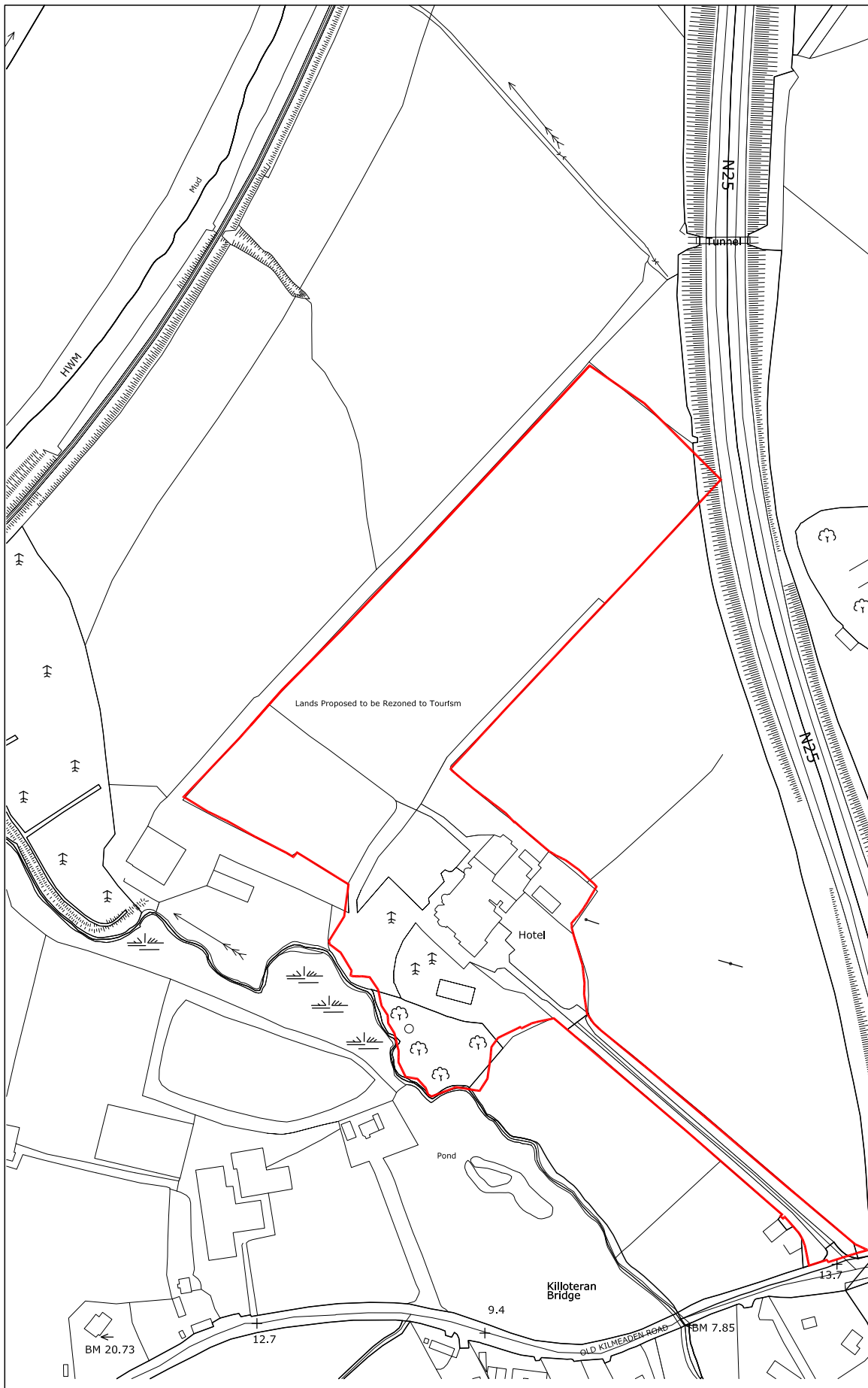

Output Format:

 DWG_3D_LEVEL

Output File:

 V_00_25318461_00000001.DWG

Map Series:

 1:2500

5700-B
 REVISION DATE = 30-Mar-2016
 SURVEY DATE = 01-Mar-1995
 LEVELLED DATE = 31-Dec-1978

5700-D
 REVISION DATE = 30-Mar-2016
 SURVEY DATE = 31-Jul-2000
 LEVELLED DATE = 31-Dec-1978

Clip Extent:

 LLX,LLY = 654766,610418
 URX,URY = 655341,610418
 LLX,LLY = 654766,611340
 URX,URY = 655341,611340

Projection:

 ITM

ITM Centre Point Co-ordinates:

 X,Y = 655054,610879

Extraction Date:

 26-Jan-2018

Copyright:

 © Suirbhéireacht Ordnáis Éireann, 2018
 © Ordnance Survey Ireland, 2018

Copyright:

 © Suirbhéireacht Ordnáis Éireann, 2010
 © Ordnance Survey Ireland, 2010

Arna thionscú agus arna fhótsú ag
 Suirbhéireacht Ordnáis Éireann, Páirc an
 Fhionnuitice, Baile Átha Cliath 8, Éire.
 Compiled and published by Ordnance Survey
 Ireland, Phoenix Park, Dublin 8, Ireland.

Sáráiríon atá ingeach naimhúdaraithe cóipcheart
 Shuirbhéireacht Ordnáis Éireann agus Riailtas
 na hÉireann.
 Unauthorised reproduction infringes Ordnance
 Survey Ireland and Government of Ireland
 copyright.

Gach cead ar cosnamh, Ní ceadmáth aon
 chuid den fhótsú seo a chóipeáil, a
 atáirgeadh nó a tharchur in aon fhoirm ná ar aon
 bhealach gan cead i scríbhinn roimh ré ó úinéir
 an chóipchearta.
 All rights reserved. No part of this publication
 may be copied, reproduced or transmitted in any
 form or by any means without the prior written
 permission of the copyright owners.

Ní hionann bóthar, bealach nó cosán a bhíonn ar
 an léarscáil seo agus fianaise ar chread sí.
 The representation on this map of a road, track
 or footpath is not evidence of the existence of a
 right of way.

Ní tháirgeánann léarscáil de chuid Ordnáis
 Shuirbhéireacht na hÉireann teorann phointe deatháil
 de mhaoin riamh, ná úinéireacht de ghnéithe fhisicéil.
 Ordnance Survey maps never show legal property
 boundaries, nor do they show ownership of physical
 features.

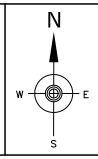

Project: Greenway Manor Hotel Old Court, Killoteran, Waterford, for Sean Johnston	
Drawing Name	Site Location Map
Drawing Number	3.01
Drawn By mw	Scale 1:2500 - A3
Date 26-01-18	Job No. 18-01

Causeway Facility Management Limited
 Sultes 9 & 10, Station House, Railway Square, Waterford
 X91XX8Y Tel: 051 352084 Email: info@causewaygroup.ie