

100
10
0
A1

DO NOT SCALE

File: 0090153-ATK-ST-XX-DR-CE-900101 - 900113.dwg
Date: Apr 11, 2025 - 10:33am
Plotted by: WSE1371

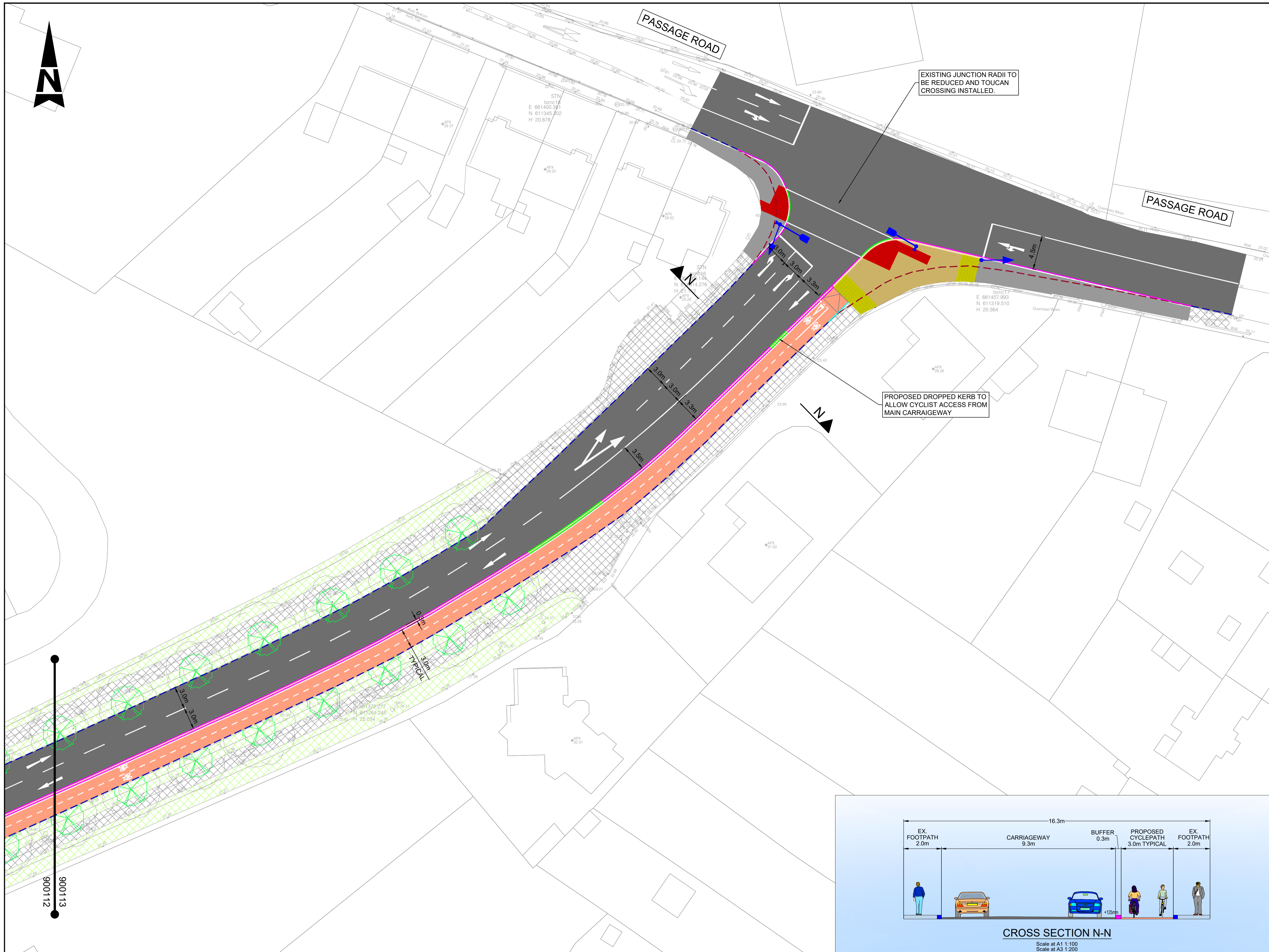

- GENERAL NOTES**
1. ALL DIMENSIONS ARE IN MILLIMETRES UNLESS NOTED OTHERWISE
 2. ONLY WRITTEN DIMENSIONS SHALL BE USED. NO DIMENSIONS SHALL BE SCALED FROM THE DRAWINGS
 3. ALL LEVELS ARE IN METRES AND ARE TO MALIN HEAD DATUM
 4. ALL COORDINATES ARE IN METRES AND ARE TO IRISH TRANSVERSE MERCATOR
 5. DRAWINGS ARE TO BE READ IN CONJUNCTION WITH THE SPECIFICATION

- LEGEND**
- PROPOSED 100mm - 125mm UPSTAND KERB
 - PROPOSED 60mm UPSTAND KERB
 - PROPOSED 6mm FLUSH KERB
 - PROPOSED EDGING KERB
 - EXISTING KERB (RETAINED)
 - EXISTING KERB (REMOVED)
 - PROPOSE BEVELLED KERB
 - AMENDED/ PROPOSED BUS BAY
 - CARRIAGEWAY
 - PROPOSED CYCLE TRACK
 - PROPOSED CYCLE LANE
 - PROPOSED MIXED TRAFFIC STREET
 - PROPOSED FOOTPATH
 - EXISTING FOOTPATH
 - EXISTING VERGE
 - PROPOSED RAISED TABLE
 - PROPOSED TRAFFIC ISLAND
 - PROPOSED VERGE
 - PROPOSED SHARED PATH
 - PROPOSED OVERRUN AREA
 - PROPOSED BUFFER
 - TACTILE PAVING (UNCONTROLLED JUNCTION)
 - TACTILE PAVING (CONTROLLED JUNCTION)
 - TACTILE PAVING (LADDER TRAMLINE)
 - EXISTING TREE TO BE REMOVED
 - EXISTING TREE TO BE RETAINED
 - PEDESTRIAN BUTTON
 - PRIMARY SIGNAL
 - SECONDARY SIGNAL
 - PEDESTRIAN SIGNAL
 - CYCLIST BUTTON
 - CYCLIST SIGNAL

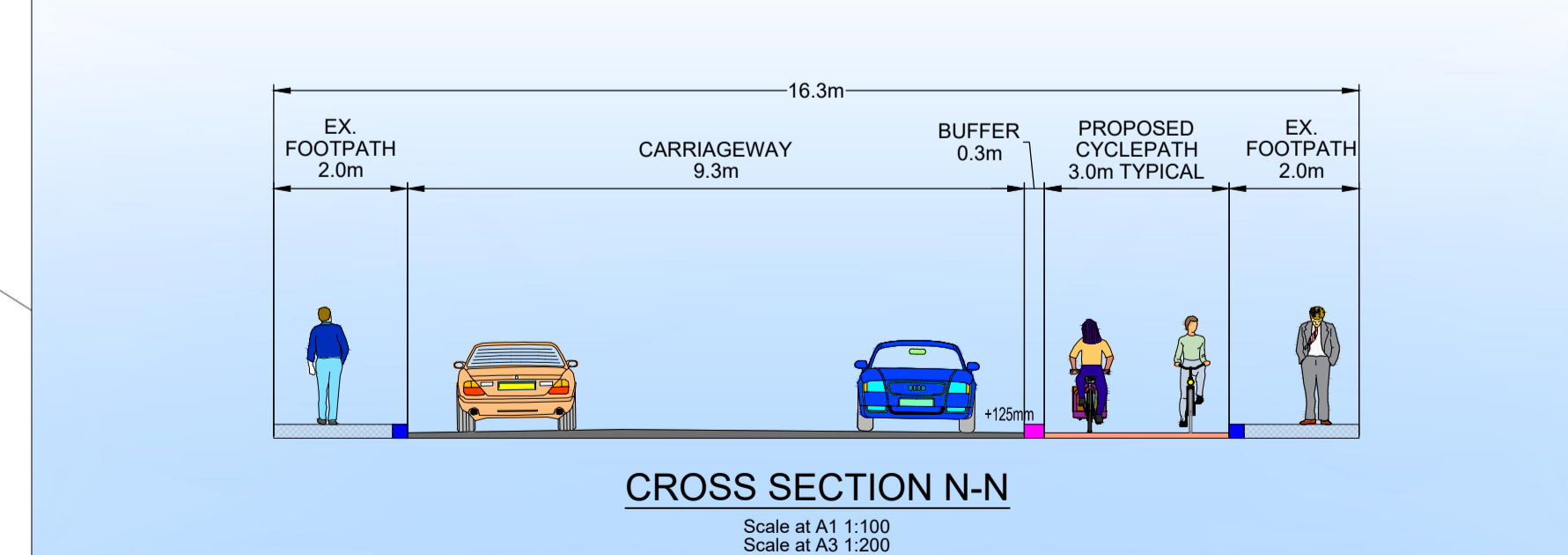

© ORDNANCE SURVEY IRELAND LICENSE NR. AR 0082524. ORDNANCE SURVEY IRELAND & GOVERNMENT OF IRELAND

ATKINS WILL NOT BE HELD LIABLE FOR THE USE OF THIS DATA ON ANY PROJECT OTHER THAN THE PROJECT.

WATERFORD ACTIVE TRAVEL PROJECTS

Risk Level	Atkins Base Line - Low Risk
	X Atkins Sensitive - Medium Risk
	Atkins Private - High Risk
	Client Critical - Already Marked

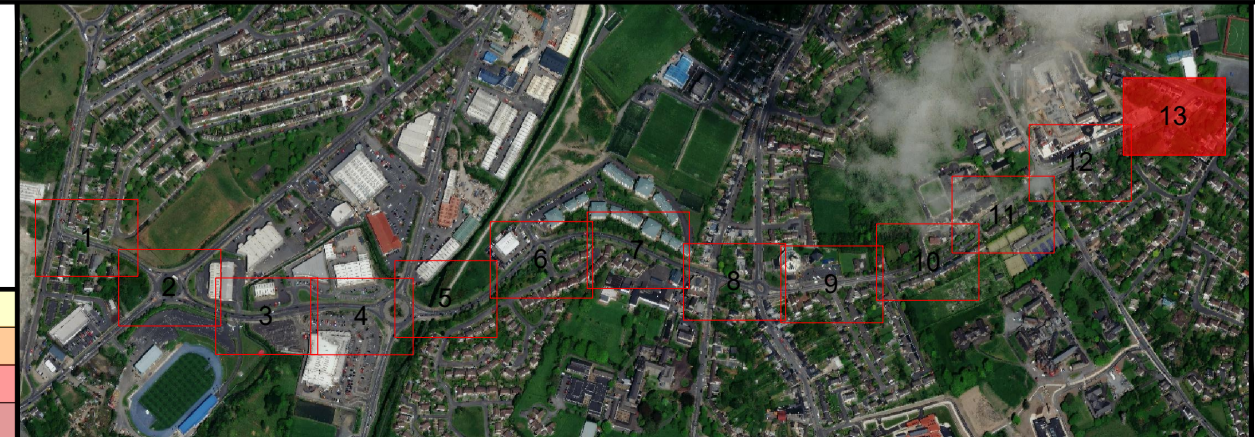

Rev	Description	By	Date	Chk'd	Rev'd	Auth
C02	SECTION 38	RC	10/04/25	SG	SW	SW
C01	FOR REVIEW	RC	13.03.25	SG	SW	SW

AtkinsRéalis

Atkins House, 150-155 Ainslie Road, Business Park, Swords, Co. Dublin
Tel (+353) 01 810 8000 Fax (+353) 01 810 8001

Unit 2B, 2200 Cork Airport Business Park, Cork
Tel (+353) 021 429 0300 Fax (+353) 021 429 0360

1st Floor Technology House Parkmore Technology Park, Galway
Tel (+353) 091 786 050 Fax (+353) 091 779 830

Client: WATERFORD CITY & COUNTY COUNCIL

Project: WATERFORD ACTIVE TRAVEL PROJECTS

Purpose	PLANNING				
Title	INNER RING ROAD PRELIMINARY DESIGN LAYOUT SHEET 13 OF 13				
Original Scale	1:250 @ A1	Drawn	RC	Checked	SW
Scale	1:500 @ A3	Date	08.11.24	Date	08.11.24
Status	A2	Drawing Number	0090153-ATK-XX-XX-DR-CE-900113	Reviewed	SW
Rev	C02	Date	08.11.24	Authorised	SW