

IMPORTANT : It is the responsibility of the Contractor to check and agree with Frank Fox & Associates all levels, datum and reference points prior to commencement of contract. This drawing shall not be altered or copied without the consent of Frank Fox & Associates.

NOTES:
 This drawing is not to be scaled:
 Figured dimensions only are to be taken from this drawing. All setting out dimensions are to be checked and confirmed on site prior to commencement of work. Any discrepancies encountered to be brought to the attention of Frank Fox & Associates without delay.
IF IN DOUBT ASK.!

Levels to OD Malin Head.
 Road chalmages and levels on this drawing are rounded. For values to nearest mm see printouts.







KEY

New Sewer
 All Foul & Storm Sewer Systems to be installed as Per Irish Water's Wastewater Infrastructure Connections & Developer Services & Irish Water's IW-CDS-5030-03, Wastewater-Code-of-Practice.

All Services to be installed to Irish Water's Separation Distances as Per Drawing STD-W-11 Rev. 2

New Foul Sewer
 All New Foul Sewer to be UPVC SNB as Per Irish Water's IW-CDS-5030-03, Section 3.13

New Storm Sewer
 All Storm Sewer to be UPVC SNB as Per Irish Water's IW-CDS-5030-03, Section 3.13

- Existing Storm Sewer and Manholes 
- New Storm Sewer and Manholes 
- Existing Foul Sewer and Manholes 
- New Foul Sewer and Manholes 
- Foul Inspection Chamber  IC03
- Site Boundary 

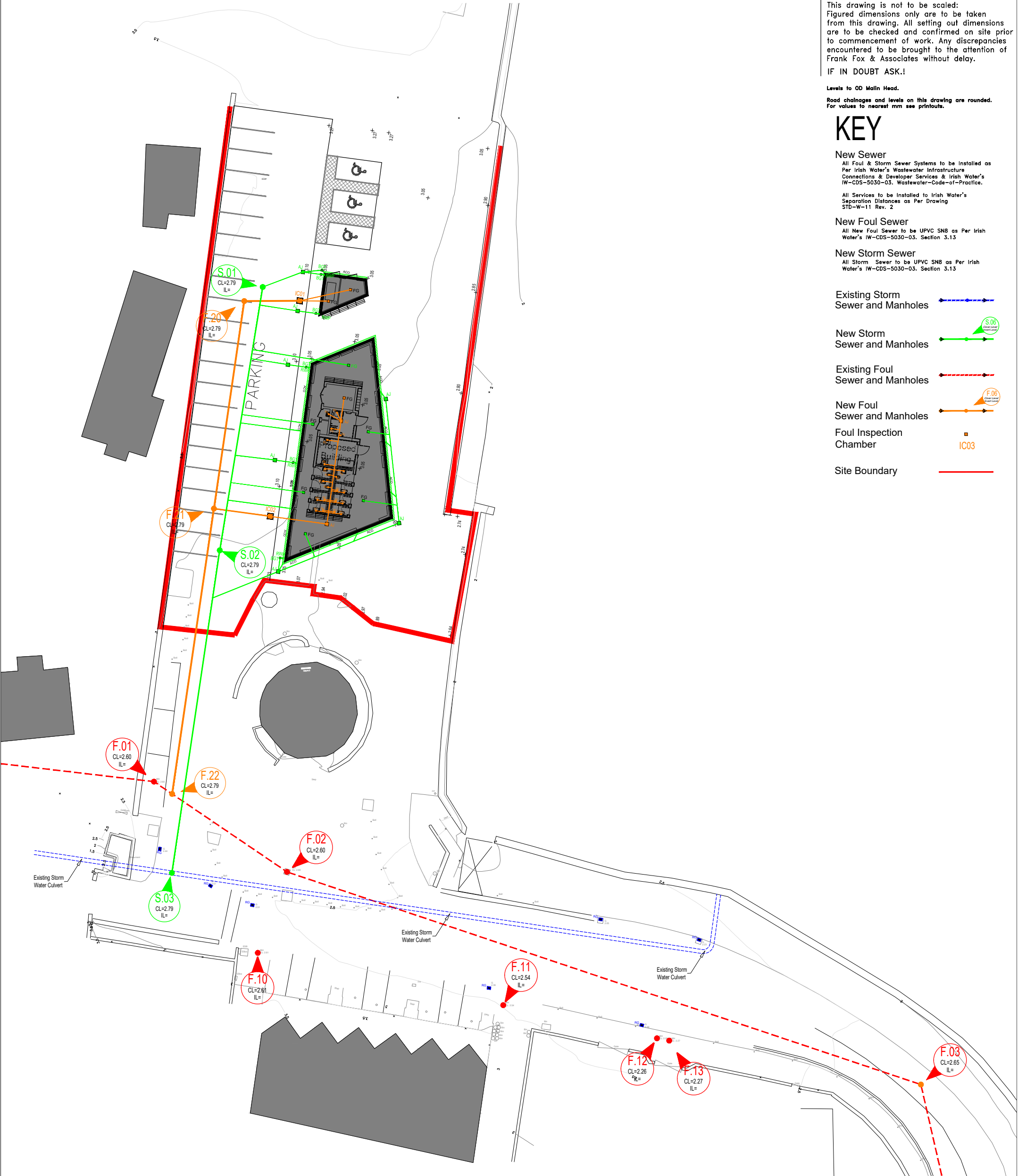

Friday 24th NOVEMBER 2023
PART 8
 THIS DRAWING IS NOT TO BE USED FOR CONSTRUCTION PURPOSES



REV	DESCRIPTION	BY	DATE

PROJECT TITLE
**WATERFORD COUNCIL.
 TRAMORE & ARDMORE
 WATER ACTIVITY CENTRES.**

DWG TITLE
**DRAINS
 PLAN**

DRAWN	CHECKED	DATE	SCALES	CAD REF.
T. Dorney	Robert Fox	10.11.2023	1:200	222061-plans

FRANK FOX & ASSOCIATES
 CIVIL & STRUCTURAL CONSULTING ENGINEERS
 7 BANK LANE WATERFORD, IRELAND
 TEL: 353-51-872799 Fax: 353-51-872626
 Email: design@ffacorp.com

PROJECT No.	DWG No.	REV
222061	DP/01	